

Stainless steel-manually operated

Technical data

Design:	9338-L-PORT 9339-T-PORT
Connection:	3-way ball valve with reduced port Threaded in acc.to DIN EN 10226-1
Body material:	Stainless steel 1.4408
Body cap material:	Stainless steel 1.4408
Ball material:	Stainless steel 1.4401
Ball seat:	R-PTFE (15%)
Stem material:	Stainless steel 1.4401
Stem packing:	PTFE FKM O-Ring
ISO Flange:	Acc.to DIN EN ISO 5211
Handle:	Stainless steel 1.4301, PVC-blue plastic sleeve, lockable
Safety:	Blow-out proof design, antistatic
Medium temperature:	-25°C up to max. +180°C, pressure dependent
Pressure rating:	Max. PN 63bar, temperature dependent
Approval:	ATEX II 2G Ex h IIB T2 Gb ATEX II 2D Ex h IIIB T280° Db



FE|FE|FE acc.to DIN EN 10226-1

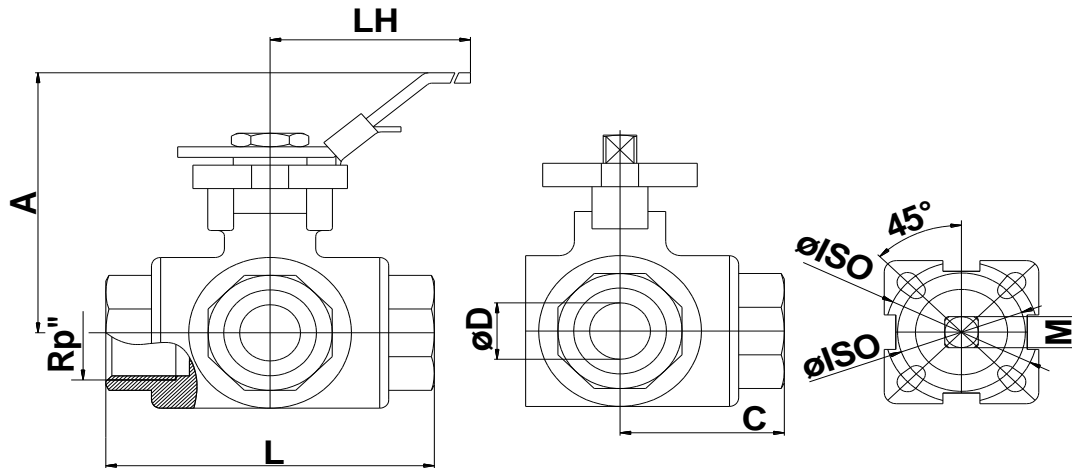

Article No.	Rp"	DN	øD mm	A mm	L mm	LH mm	C mm	M mm	Nm	øISO	Weight L [Kg]	Weight T [Kg]
9338 9339-02	1/4"	8	9,5	66	75	130	37,5	9	8	F03 F04	0,70	0,70
9338 9339-03	3/8"	10	11	66	75	130	37,5	9	8	F03 F04	0,67	0,67
9338 9339-04	1/2"	15	12	66	75	130	37,5	9	8	F03 F04	0,63	0,63
9338 9339-05	3/4"	20	15	72	85	161	42,5	11	9	F04 F05	0,94	0,94
9338 9339-06	1"	25	20	77	100	161	50	11	15	F04 F05	1,39	1,38
9338 9339-07	1 1/4"	32	25	92	122	203	61	14	20	F04 F07	2,91	2,89
9338 9339-08	1 1/2"	40	32	96	131	203	65,5	14	30	F05 F07	3,66	3,60
9338 9339-09	2"	50	40	107	158	203	79	14	45	F05 F07	6,31	6,21
9338 9339-10	2 1/2"	65	49	135	178	254	89	17	50	F07 F10	8,95	8,72
9338 9339-11	3"	80	60	147	202	254	101	17	80	F07 F10	13,11	12,81
9338 9339-12	4"	100	75	160	246	310	123	17	110	F07 F10	22,10	21,60

Flow value

9338 9339 Gr.	02	03	04	05	06	07	08	09	10	11	12
KV value [cbm/h]	11	11	13	15	31	39	62	103	205	232	412