

### Stainless steel

#### TECHNICAL DATA BALL VALVE:

|                          |  |
|--------------------------|--|
| Construction:            | 2-way full bore ball valve                                       |
| Design:                  | 2-part design  |
| Connection end:          | Flange according to DIN 2501/1-EN 1092-1                         |
| Body:                    | Stainless steel 1.4408   |
| Ball:                    | Stainless steel 1.4401 with flushing hole                        |
| Stem:                    | Stainless steel 1.4401 Blow-out proof                            |
| Ball seal:               | PTFE TFM1600   |
| Stem seal:               | PTFE   FKM O-ring  |
| Body wall thickness:     | According to EN 12516-1  |
| Face to face dimension:  | According to EN 558-1 series 27                                  |
| Flange PN40              | DN15-DN50  |
| Flange PN16              | DN65-DN200   |
| Actuator connection:     | Acc.to DIN EN ISO 5211 [direct assembly]                         |
| Medium temperature:      | 0°C up to +65°C pressure dependent<br>[90°C for max. 30 Minutes] |
| Medium nominal pressure: | Max. 10 16 bar temperature-dependent                             |
| Inspection&Test :        | DIN 3230/3 - EN 12266  |

#### Approval:



DIN DVGW DRINKING WATER  
DIN EN 13828 | DVGW W570-1 PN10 up to DN100  
DIN EN 1074-1 | DIN EN 1074-2 PN16 up to DN 200

#### TECHNICAL DATA ACTUATOR

|                         |   |
|-------------------------|---|
| Functionality :         | *OPEN* * CLOSE  |
| Control voltage :       | AE01: 230V AC 50/60 Hz.<br>AE02: 24V DC                           |
| Power consumption :     | AE01: 6 W<br>AE02: 8 W  |
| Operating temperature : | - 25°C up to max. + 55°C  |
| Operating time :        | approx. 15 sec. for 90° at 18 Nm                                  |
| Angle of rotation :     | set 90 ° for ball valves max. 360 °                               |
| Torque max :            | 18 Nm   |
| Protection class :      | IP 64   |
| Electrical connection : | 1 external plug for voltage<br>1 external plug for signal         |
| Limit switch :          | 2 pieces for 90° rotation<br>2 pieces for feedback *Open* *Close* |
| Position indicator:     | optical   |
| Actuator connection:    | Acc.to DIN EN ISO 5211 [direct assembly]                          |
| Star:                   | F03 F04 F05 square 9x9 11x11                                      |
| Housing cover:          | Aluminium alloy coated  |
| Manual override:        | Allen key   |

### Flange connection

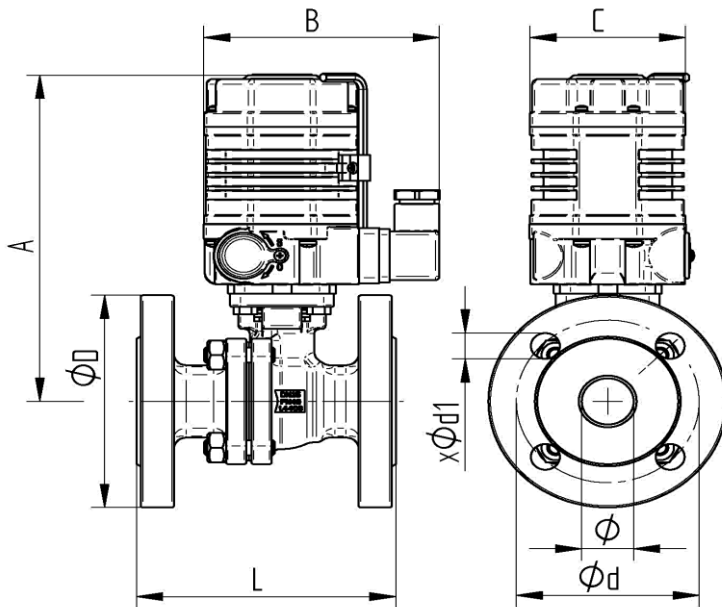

| Item Nr. 230V 50 Hz. | Item Nr. 24V DC | DN | ø mm | A mm | B mm | C mm | L mm | øD mm | ød mm | xød1 mm |
|----------------------|-----------------|----|------|------|------|------|------|-------|-------|---------|
| AE010930-04          | AE020930-04     | 15 | 15   | 169  | 116  | 75   | 115  | 95    | 65    | 4xø14   |
| AE010930-05          | AE020930-05     | 20 | 20   | 174  | 116  | 75   | 120  | 105   | 75    | 4xø14   |
| AE010930-06          | AE020930-06     | 25 | 25   | 180  | 116  | 75   | 125  | 115   | 85    | 4xø14   |