

Stainless steel

TECHNICAL DATA

operating temperature:	-20°C to max. +180°C, dependent on pressure drinking water 0°C bis 65°C, pressure-dependent
working pressure:	max. PN 40 bar, drinking water PN10
connecting thread:	according to DIN EN ISO 228/1
body material :	stainless steel 1.4408
female end:	stainless steel 1.4408
ball :	stainless steel 1.4408
ball seal :	TFM 1600
stem :	stainless steel 1.4401
stem seals :	TFM 1600/ O-Ring EPDM 70 55985
lever:	stainless steel, green plastic cover



Certification:  DIN-DVGW-drinking water acc.
to DIN EN 13828 and W 570/1

Connecting thread female/male

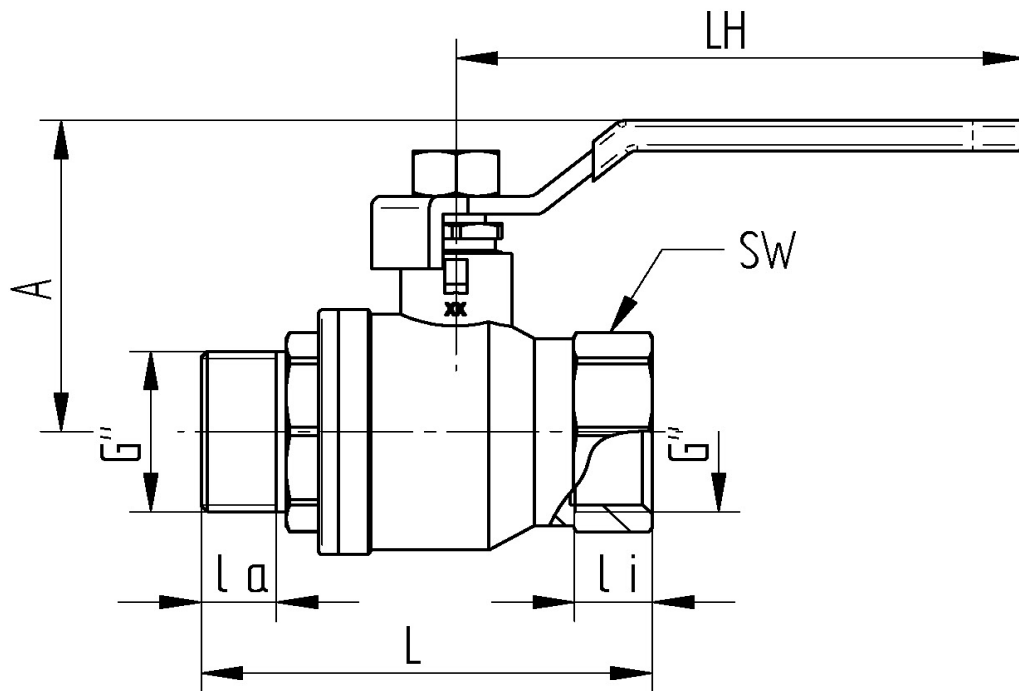

Art. Nr.	G"	DN	A mm	LH mm	li mm	la mm	L mm	SW mm	PN bar	Gewicht (g)
9391-03	3/8"	10	61,5	94	9	9	48	20	40	164
9391-04	1/2"	15	67	94	10	12	61	25	40	248
9391-05	3/4"	20	72,5	94	11,5	11,5	69	31	40	358
9391-06	1"	25	79,5	115	13	15	80,5	38	40	527
9391-07	1 1/4"	32	86,5	130	16	15	90,5	48	25	911
9391-08	1 1/2"	40	93,5	130	16	15	101,5	54	25	1215
9391-09	2"	50	106,5	154	16	18,2	115	66	25	2121