

## Brass

### TECHNICAL DATA

Operating temp. liquids :	- 15°C to max. + 110°C, depending on pressure
Operating temperature gas :	- 20°C to max. + 60°C, depending on pressure
Operating pressure gas :	MOP 5 / PN5
Operating pressure liquids :	Compressed air max. 20 bar
Connection thread :	according to DIN EN 10226-1 long thread
Housing material :	Brass CW617N
Ball :	Brass CW617N chrome-plated
Ball seals :	PTFE
Stem :	Brass CW617N blow-out proof
Stem seals :	PTFE / HNBR
Butterfly lever :	Die-cast aluminum, yellow coated

**Approval:** DIN-DVGW-gas, EN 331

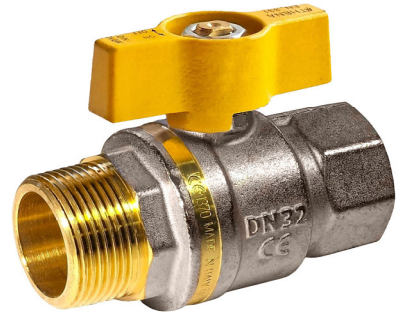

### Connecting thread female / male

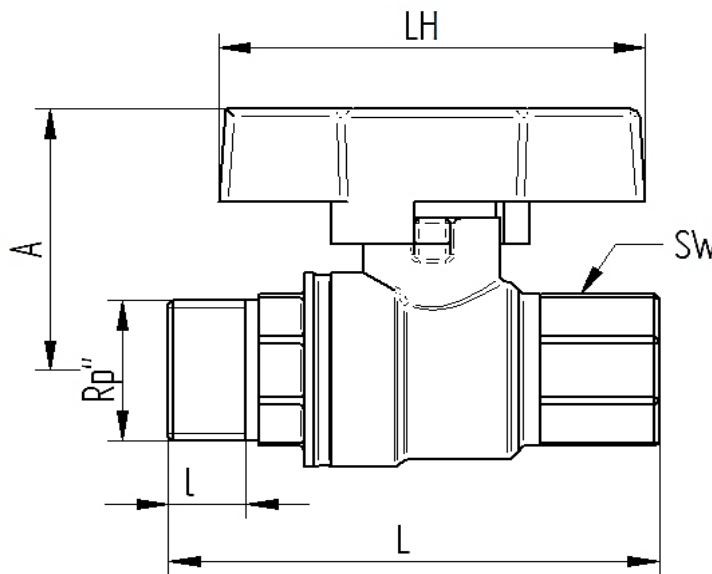

Art.Nr.	Rp"	øD	L mm	la mm	li mm	A mm	LH mm	SW mm	PN (bar)	weight (g)
667-02	1/4"	8	54	12	12	31	47	21	40	118
667-03	3/8"	10	54	12	12	31	47	21	40	129
667-04	1/2"	15	67	17	16	35	47	26	40	189
667-05	3/4"	20	78	19	16	41	56	31	40	322
667-06	1"	25	89	22	20	45	56	38	40	467