

## Brass

### Technical data

Construction:	2-way ball valve, reduced passage
Construction:	2-part design
Connection end:	female thread according to DIN EN 10226-1
Body:	CW617N nickel plated
Screw-in socket:	CW617N nickel plated
Ball:	CW617N , bright chrome plated
Spindle:	high strength DELRIN
Ball seal:	CW617N
Stem seal:	PTFE / FKM
Operating temperature :	-10°C to +80°C, pressure dependent
Operating pressure :	max. PN 210 bar compressed air max. 20 bar
Hand lever:	Aluminum alloy, black painted
Automation:	Electric   pneumatic actuator possible
Approval :	<input type="checkbox"/> EAC acc.to TR CU 010/2011
On request:	Sealings for higher temperatures

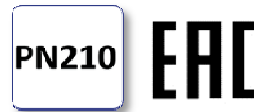

### Connecting thread female / female

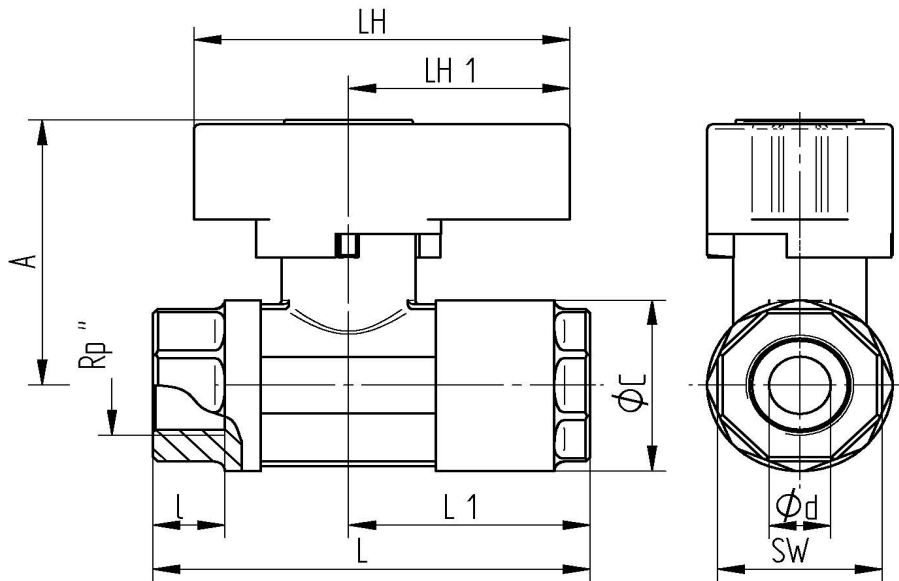

Item No.	Rp"	ød mm	L mm	L1 mm	l mm	A mm	LH mm	LH1 mm	øC mm	SW mm	PN (bar)	weight (g)
814-03	3/8"	8	75	44	12	54	73	43	30	26	210	482
814-04	1/2"	12	85	47	14	56	73	43	36	32	210	637
814-05	3/4"	16	95	54	16	75	110	68	45	39	210	1179
814-06	1"	20	105	56	19	77	110	68	53	48	210	1536