

Brass

TECHNICAL DATA

| | |
|---------------------|--|
| temperature range : | - 20°C up to max. + 120°C, pressure-dependent (EPDM) |
| pressure range : | max. PN 10 bar |
| connecting thread : | according to DIN EN ISO 228-1, reduced bore |
| body material : | Brass CW617N hard chromium plated |
| ball : | Brass CW614N hard chromium plated |
| ball seals : | PTFE |
| stem : | Brass CW617N nickel plated |
| stem seals : | EPDM |
| lever: | Aluminium alloy black |



Connecting thread female / female

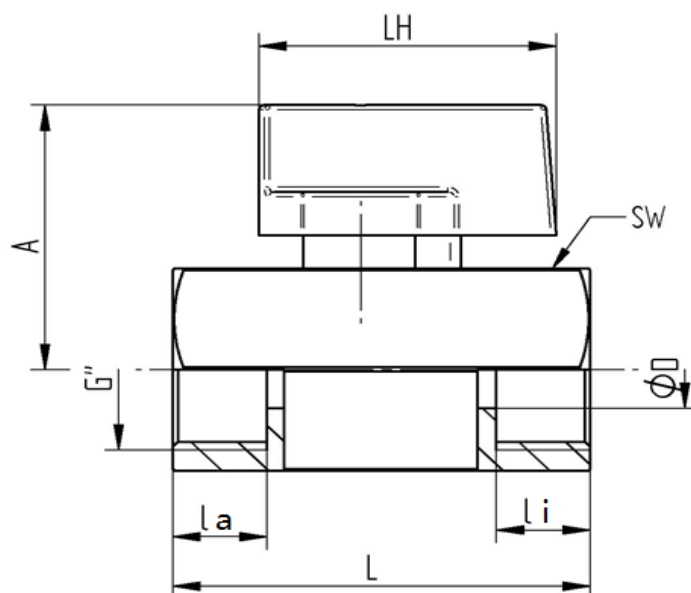

| Art. Nr. | G" | øD mm | L mm | li mm | la mm | A mm | LH mm | SW mm | PN bar | weight (Kg) |
|----------|------|-------|------|-------|-------|------|-------|-------|--------|-------------|
| 500-01 | 1/8" | 6 | 40 | 9,5 | 9,5 | 26 | 32 | 20 | 10 | 0,100 |
| 500-02 | 1/4" | 8 | 41 | 10 | 10 | 26 | 32 | 20 | 10 | 0,095 |
| 500-03 | 3/8" | 8 | 40,5 | 10 | 10 | 26 | 32 | 20 | 10 | 0,078 |
| 500-04 | 1/2" | 10 | 45,5 | 10 | 10 | 28 | 32 | 23,8 | 10 | 0,120 |
| 500-05 | 3/4" | 12 | 54 | 10 | 10 | 32,7 | 32,8 | 30 | 10 | 0,203 |