

Brass - long thread version

TECHNICAL DATA

temperature range:	- 20°C up to max. + 150°C, pressure-dependent
pressure range :	max. PN 40 bar, depending on nominal size and temperature
connecting thread:	long thread, according to DIN EN ISO 228-1
body material:	Brass CW617N nickel plated
threaded ends:	Brass CW617N nickel plated
ball:	Brass CW614N chromium plated
ball seals:	PTFE
stem:	Brass CW617N nickel plated
stem seals:	PTFE , O-Ring FKM with packing gland
handle:	steel, red plastic coated



Connecting thread female / male

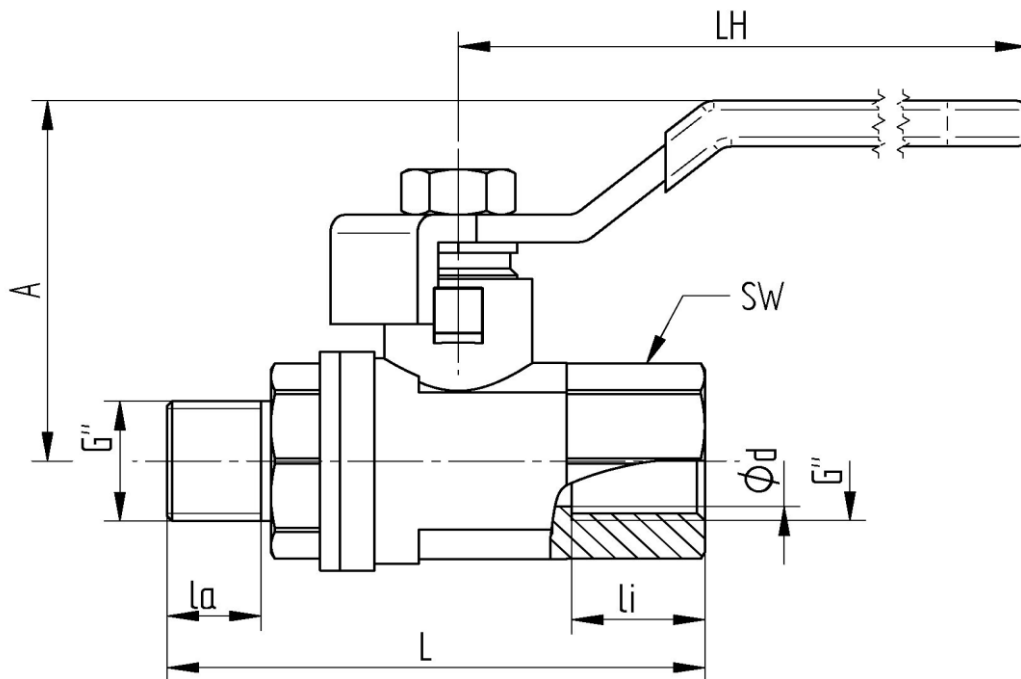

Art.Nr.	G"	DN	ød mm	L mm	li mm	la mm	A mm	LH mm	SW mm	PN	weight (g)
757-02	1/4"	8	10	54,5	14	12	40	91	20	40	144
757-03	3/8"	10	10	54,5	14	13	40	91	20	40	133
757-04	1/2"	15	14	65	17,5	16,5	45	91	26	40	211
757-05	3/4"	20	19	70	19	17,5	49	91	32	32	290
757-06	1"	25	24	86,5	24	20	56	100	40	32	496
757-07	1 1/4"	32	32	99	24	22,5	68	130	50	25	853
757-08	1 1/2"	40	38	104	24	23	73	130	55	25	1250
757-09	2"	50	50	124	29	27	93	154	68	25	2010