

## Brass

### TECHNICAL DATA

temperature range :	-20°C up to max. +150°C, pressure-dependent
pressure range :	max. PN 40 bar
compressed air:	max. 10 bar
connecting thread:	according to DIN EN ISO 228-1
body material:	Brass CW617N nickel plated
threaded ends:	Brass CW617N nickel plated
ball:	Brass CW614N chromium plated
ball seals:	PTFE
stem:	Brass CW614N nickel plated
stem seals:	PTFE , O-Ring FKM with packing gland
handle:	extended plastic with isolating sleeve, black



### Connecting thread female / male

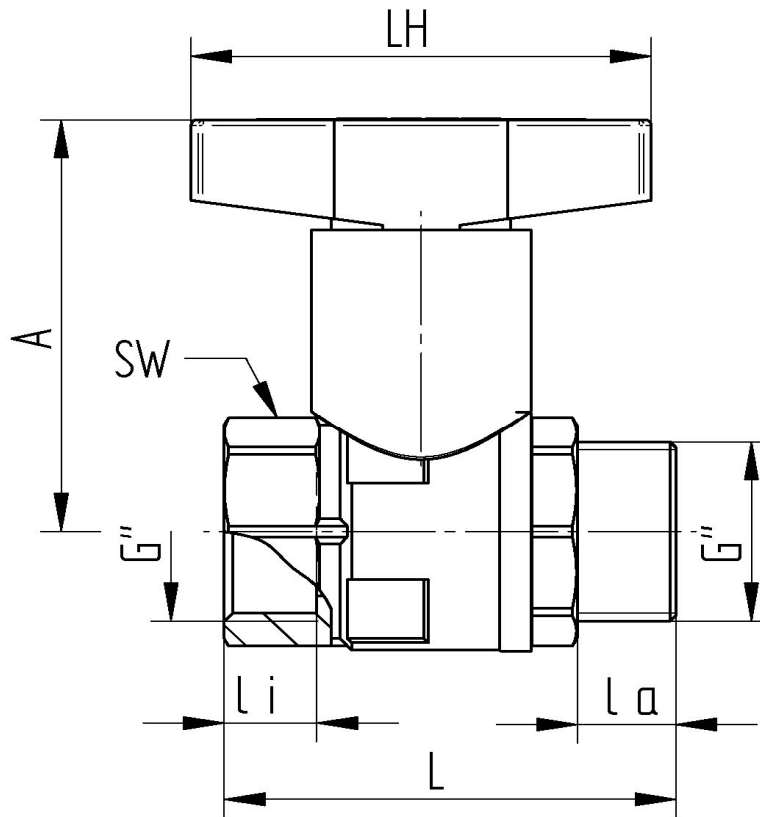

Art. Nr.	G"	øDN	L mm	li mm	la mm	A mm	LH mm	SW mm	PN bar	weight (g)
686-04	1/2"	15	56	12,5	13	66	80	26	40	228
686-05	3/4"	20	60	12,5	13	70	80	32	40	307
686-06	1"	25	78	16	17	77	80	40	32	546
686-07	1 1/4"	32	86,5	14	16,5	87	120	48	25	736
686-08	1 1/2"	40	95	14,5	17	92	120	54	20	982
686-09	2"	50	115	19,5	17,5	106	120	68	20	1626